

## Installation of PT30



- Open ELDmandate HOS

**Note:**

- DO NOT pair Bluetooth in your phone/tablet settings. The connection will be established in the application.
  - Plug the device into the vehicle port, BEFORE turning on the vehicle and BEFORE running the application.
  - When the green LED becomes solid, the device is registered on the vehicle bus and you can run the application.
- Login to the app using a driver account
  - On the main dashboard, tap the 'Connect' button which is located below the app header to display the 'Connect to Vehicle' dialog.
  - At this point, 2 options were present in order to establish a connection to the VBUS device: Manual Connection and Auto Connection.

## A. Manual Connection

- Tap on the 'Manual Connection' button

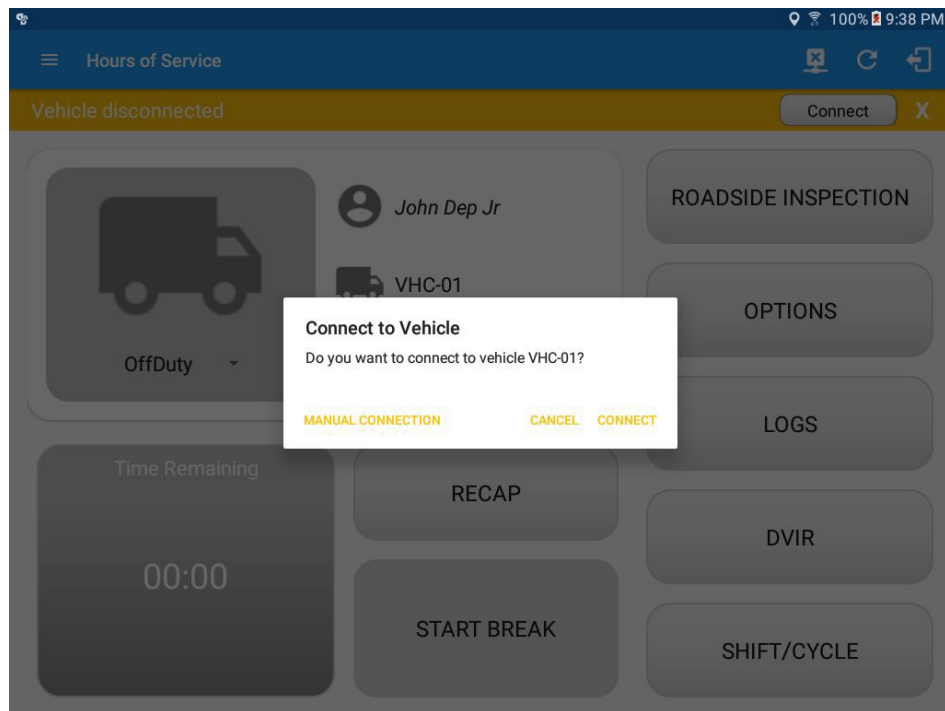

- Select VBUS Device - Pacific Track

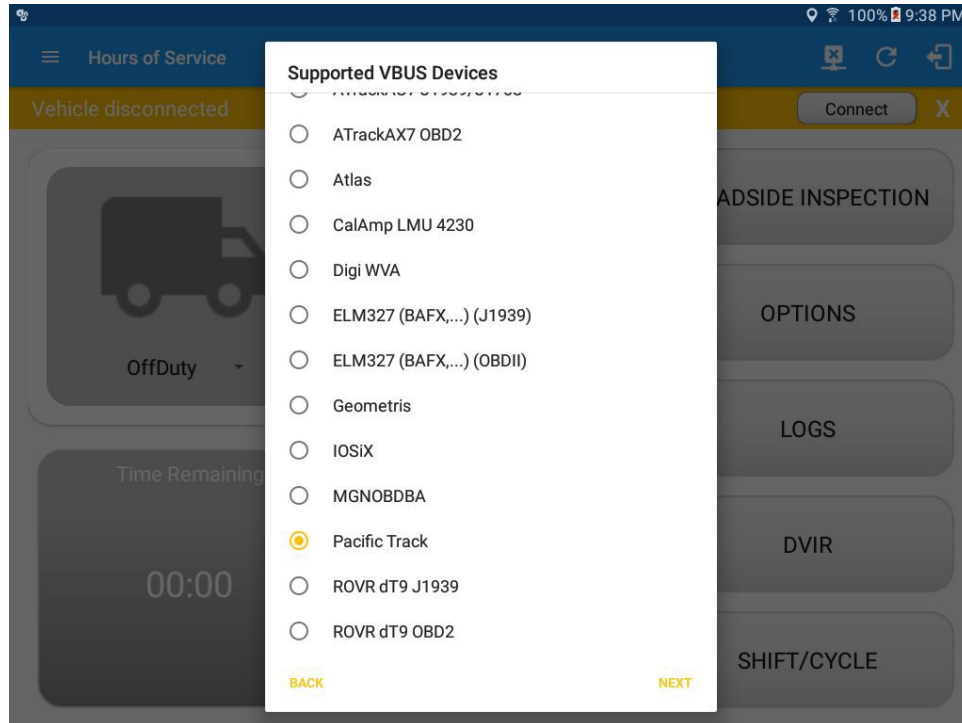

- Tap on the Next button
  - If the Bluetooth of the device is disabled, the **'Bluetooth Permission Request'** dialog will be displayed.

# Installation Guide for PT30

- Tap on the Yes button to enable the Bluetooth of the device

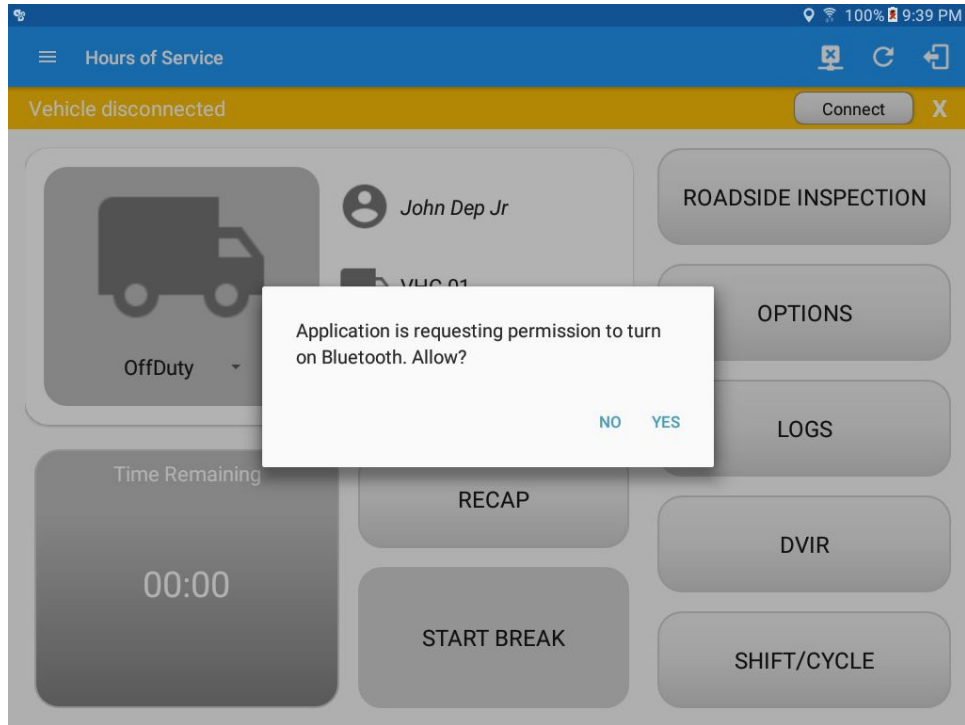

- Choose the correct Bluetooth device from the list

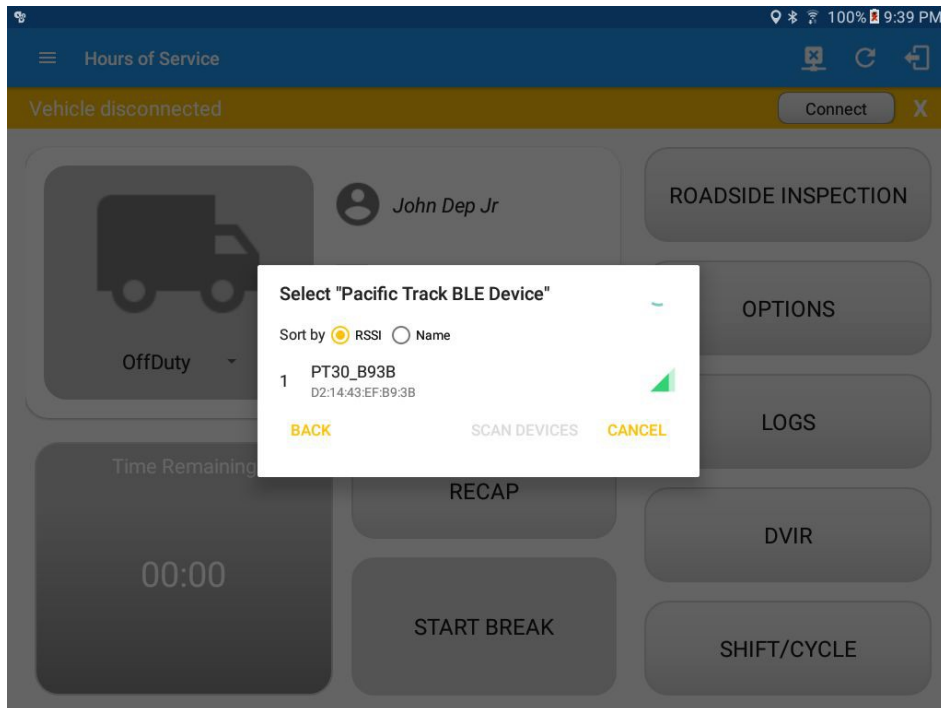

# Installation Guide for PT30

- It will then display the VBUS Progress dialog upon establishing a connection to the selected VBUS device along with a 'Stop Connection' and 'Ok' buttons:
  - A. Tap 'Stop Connection' button to stop establishing VBUS connection.
  - B. Tap OK button to hide the VBUS Progress dialog while establishing VBUS connection.

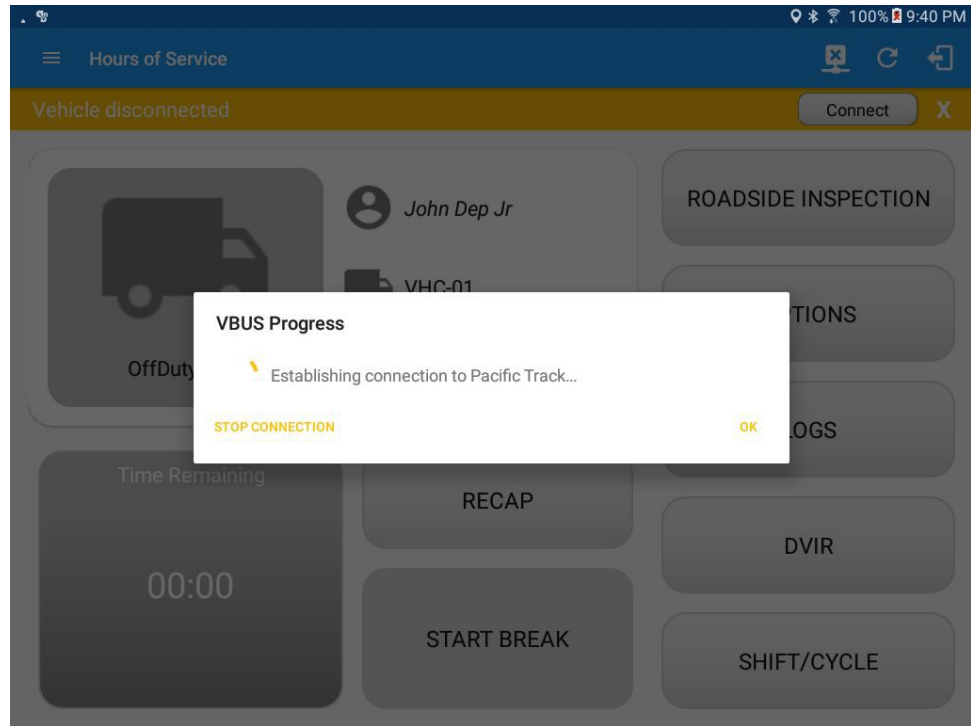

- If the VBUS connection results to an error (given the following situations below), an error dialog will display.
  - VBUS Data Error
    - i. Interrupted Internet Connection

## ii. VBUS Power Failure

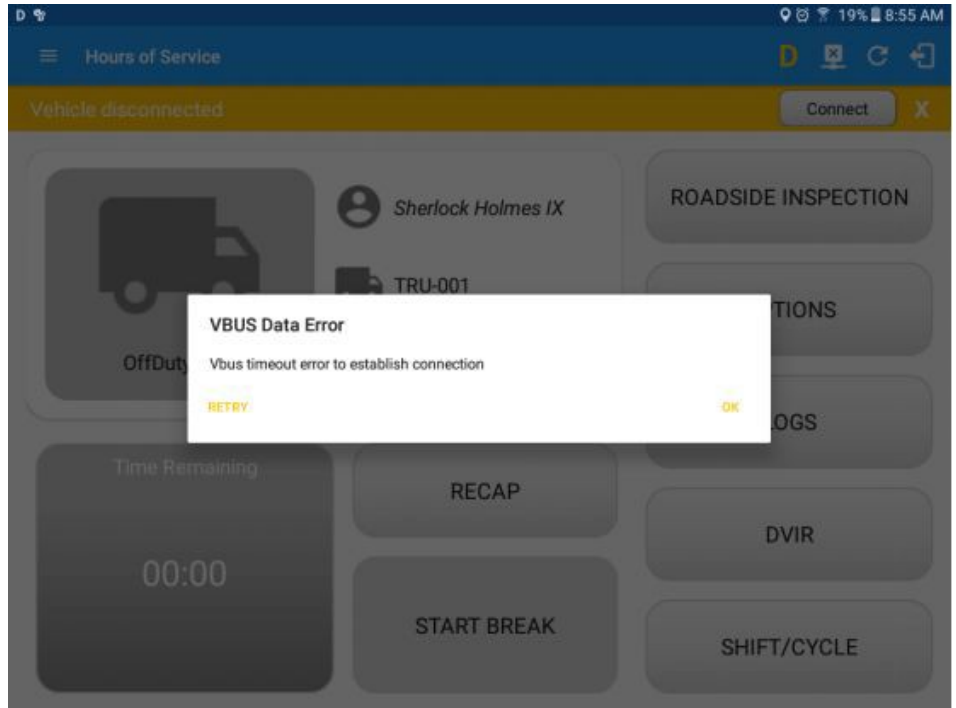

**Note:** The app will automatically disconnect from the device after attempting to connect for 1 minute and 30 seconds without receiving any data from the VBUS device.

- Upon establishing a connection to the VBUS device you should hear a tone letting you know that device is now connected.

# Installation Guide for PT30

- When the app is successfully connected to the VBUS device, the Update Firmware dialog will then be displayed to check if there are any firmware updates

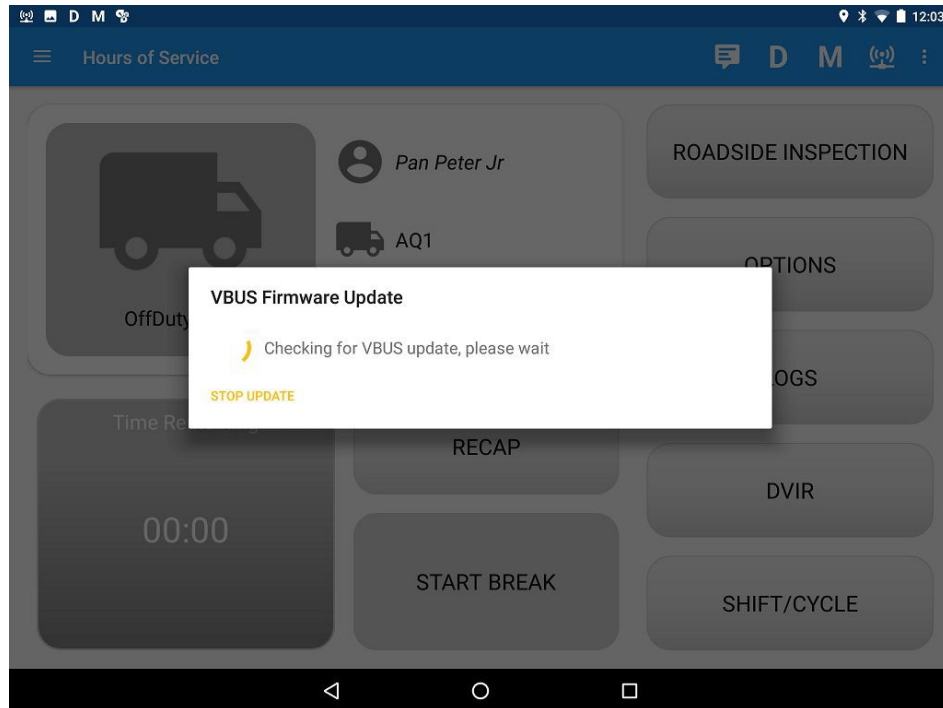

- After checking VBUS update, if there's an update available, a dialog will then be displayed asking if you want to "Update Pacific Track Firmware?" along with

# Installation Guide for PT30

'Stop Update' and 'OK' buttons.

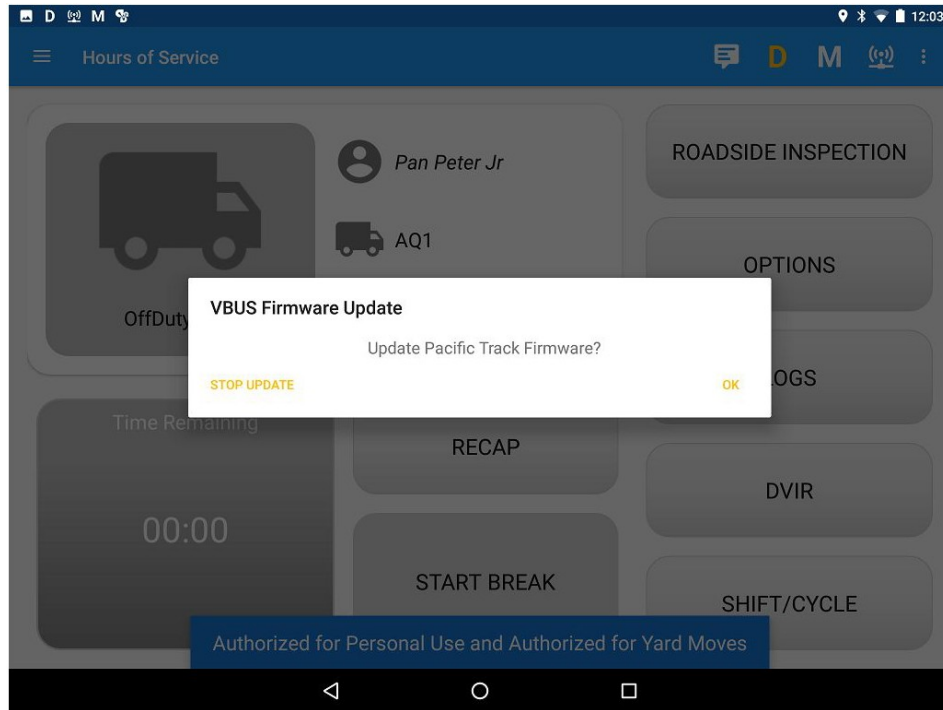



- o Once OK button is tapped, a dialog for updating the VBUS firmware will then be displayed.

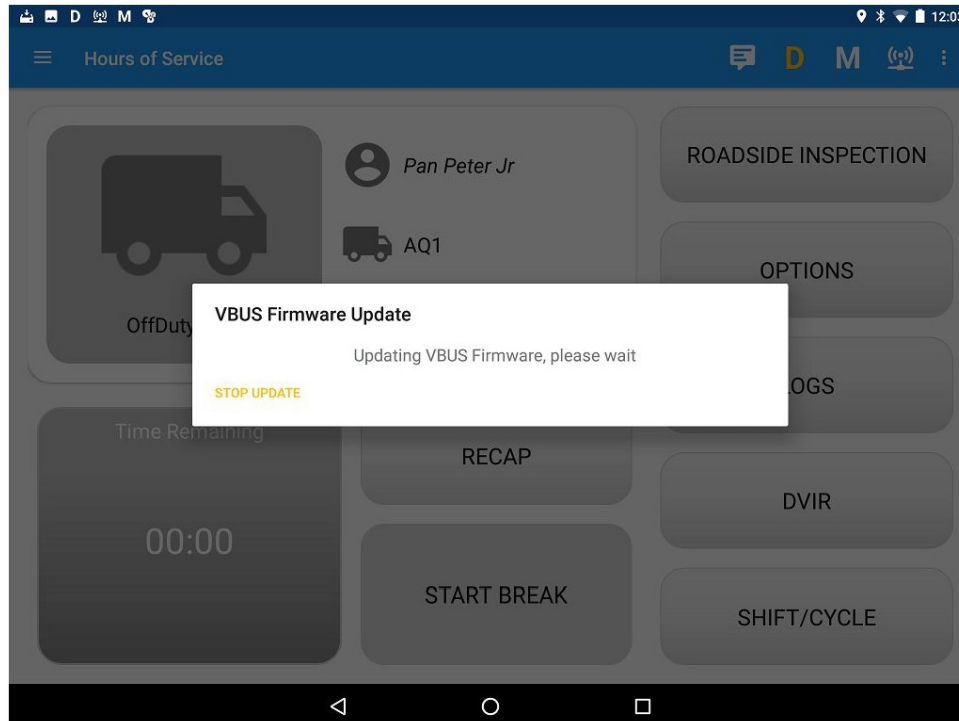

# Installation Guide for PT30

- Upgrading of the latest Pacific Track Firmware will then start and can be seen the progress in the Android Notification bar.

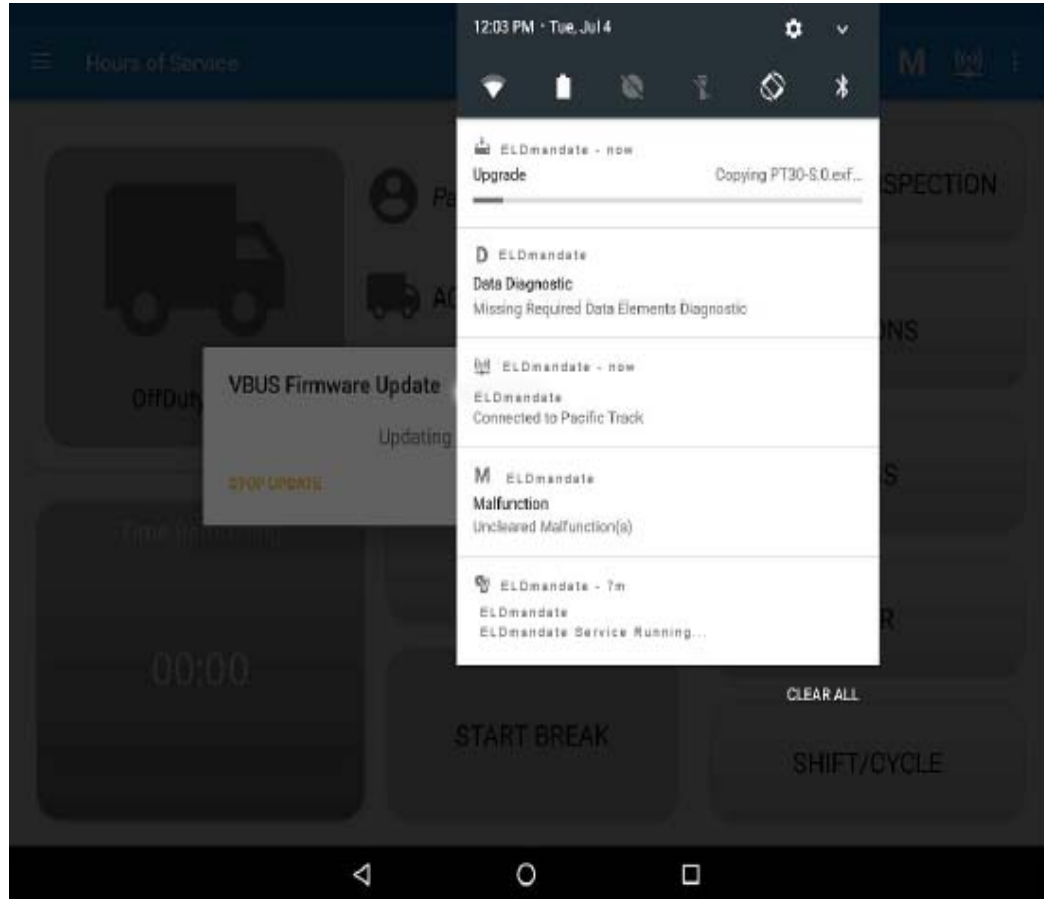

# Installation Guide for PT30

- When the update is completed, a confirmation dialog will be displayed stating: “Pacific Track firmware update complete.”

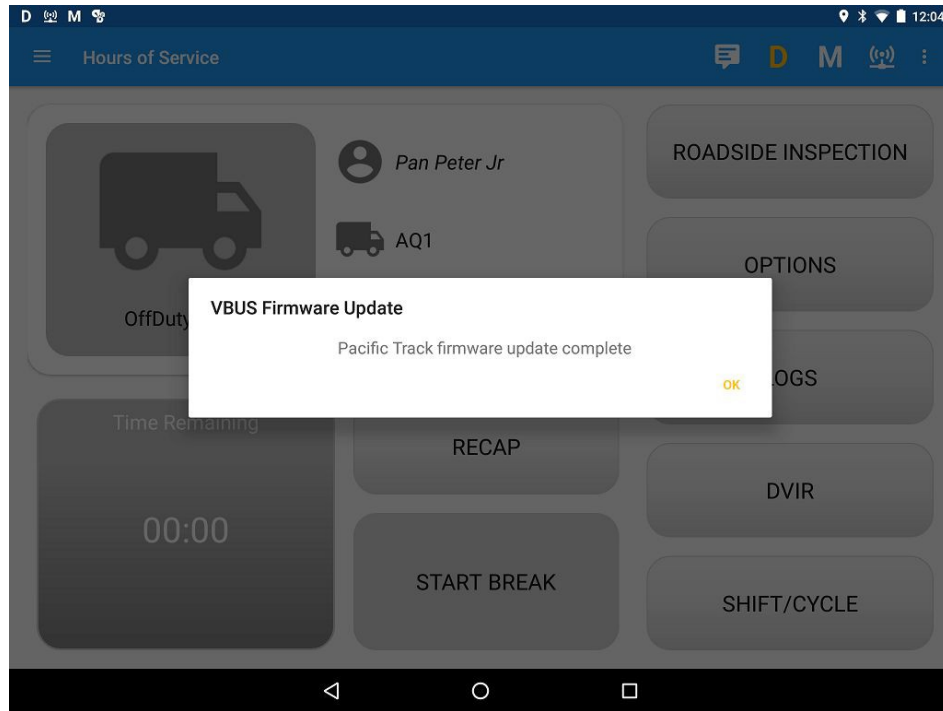

- To check if you are connected, navigate to the Main Dashboard and the VBUS status indicator should be displayed as “Connected”  which is located on



# Installation Guide for PT30

the app header.

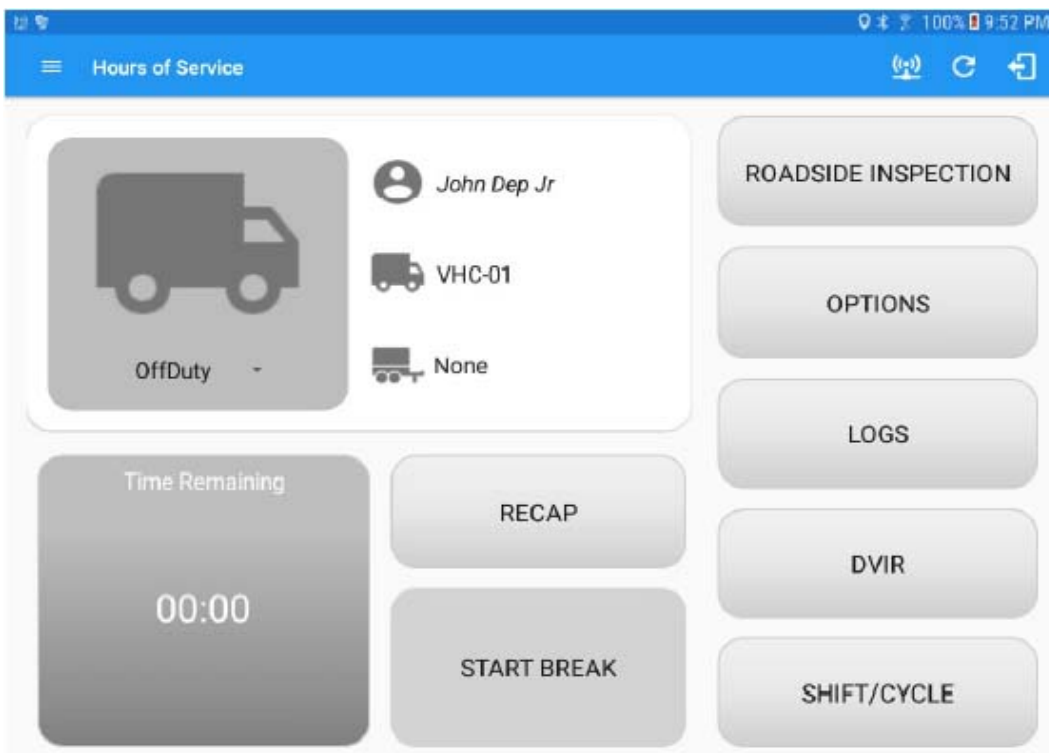

# Installation Guide for PT30

- You can also check on the Android Notification Bar and you should see the VBUS Service status as “Connected”.

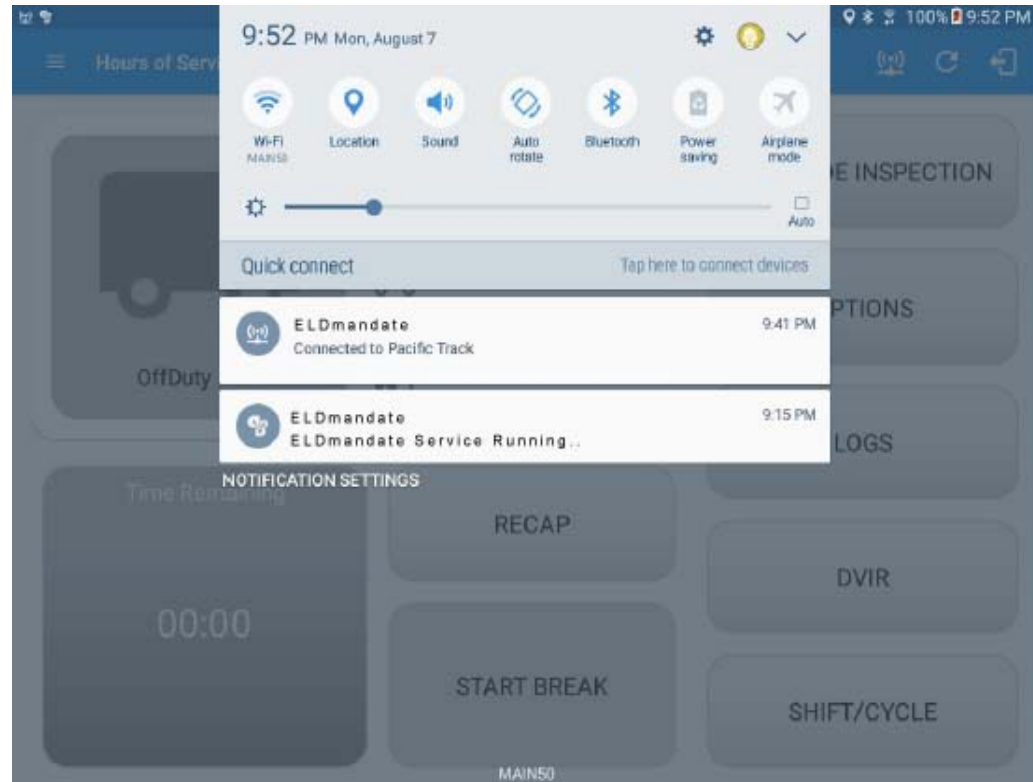

- The device and the application are now connected.

## B. Auto Connection

- Tap on the Connect button
- The VBUS Progress dialog will then display
- Upon establishing a connection to the VBUS device, You should hear a tone letting you know that device is now connected.
  - Prerequisites to successfully perform Auto Connection
    - Create a Pre-configured device in the Portal’s Equipment Management Page or in the App’s Manage Vehicles/Trailers screen
    - Set the ELD Configurations
 

**Note:** Only users allowed to Manage Equipment can create equipment in the app.